

# SmartBin

## CABINET STORAGE SYSTEM WITH WEIGHT-BASED SENSING FOR CRITICAL, HIGH-VOLUME ITEMS

Introducing the exciting new SmartBin™, the weight-based, absolute-control, cost-effective inventory management solution in SupplyPro's Smart Cabinet product line. Engineered for precise control and tracking of bulk products, this electronically accessed cabinet efficiently caters to various sizes and types of durables and consumables, offering one of the lowest cost-per-SKU systems on the market. SmartBin can be purchased as a standalone unit or seamlessly integrated with other bin or non-bin cabinets within the Smart Cabinet product line. Going beyond conventional limitations, SmartBin comes in 4 fixed configurations. At the maximum capacity, SmartBin can accommodate 64 distinct SKU's and at the lowest capacity, can accommodate 30 SKU's. Discover unparalleled tracking and control with SmartBin — the cost-effective solution for controlled inventory management.

### SMARTBIN DELIVERS

- **Secure Access & Accountability:** Ensure the security of your inventory through controlled access, maintaining precise accountability for every item.
- **Outstanding Value:** Maximize your investment with a low cost-per-SKU inventory management system, providing exceptional value.
- **Efficiency & Productivity:** Accurate tracking and control of bulk items providing efficient replenishment and productivity.
- **Speed of Transactions:** SupplyPro's weight-based sensing technology significantly increases transaction speed and reduces restocking time.
- **Scalability:** Effortlessly expand your inventory management capabilities by integrating additional cabinets.
- **Real-time Visibility:** Immediately gain insights into your inventory with real-time monitoring, tracking and reporting.
- **Four Configurations:** Choose the cabinet configuration to meet your specific product needs.

### FEATURES

- SmartBin comes standard with an RFID badge reader to identify employee access to cabinet. Optional fixed barcode, magstripe or Wiegand readers are available.
- Powered by SupplyPro's new Device Driver™ 1 firmware.
- Available as a Main device with industrial touchscreen monitor and badge reader or as an Auxiliary device to other Smart Cabinet devices.
- Optimal product availability insight, utilizing SupplyPro's user-friendly cloud-based software and standard or customized reports and dashboards.



#### MEDIUM CAPACITY 1 SMARTBIN

SmartBin comes in four different configurations. The above medium-capacity configuration can accommodate 50 SKU's and is just one of the four offered. (See back for the three additional configurations.)

ROW	BIN SIZE (HxW)	# BINS
1	4" x 4"	8
2	4" x 4"	8
3	4" x 4"	8
4	4" x 4"	8
5	6" x 6"	6
6	6" x 6"	6
7	6" x 6"	6
<b>TOTAL</b>		<b>50</b>

All lengths are 18"

### APPLICATIONS

Fasteners • Fittings  
Welding supplies • Cutting tools  
Spare/critical parts • Electronics  
Electrical connectors and terminals  
Sensors • Safety equipment  
Bearings • Abrasives • Switches  
Nuts • Bolts • Rivets • Tools

## DIMENSIONS

SmartBin comes in 4 fixed configurations.

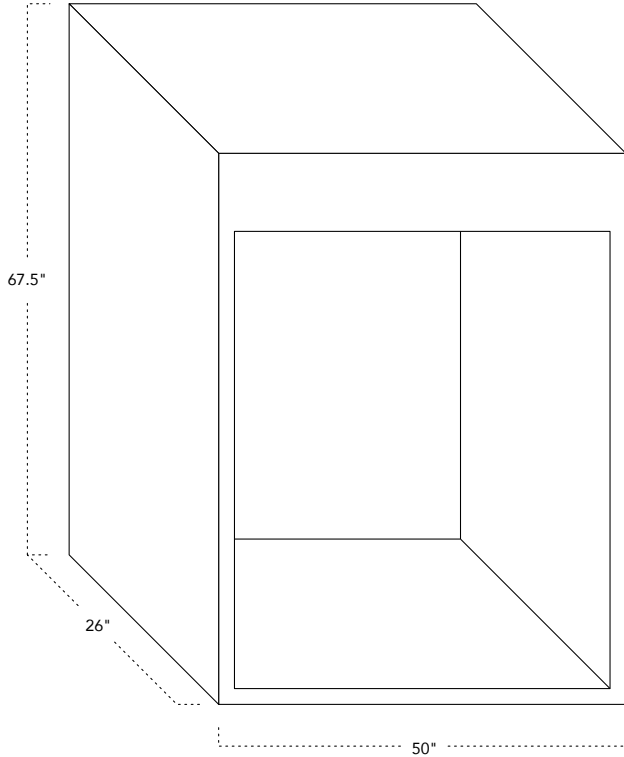

RFID badge reader is standard. Optional fixed barcode, magstripe and Wiegand readers are available.



## CONFIGURATIONS

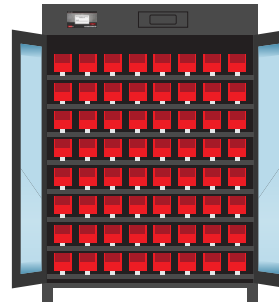

**MAXIMUM-CAPACITY SMARTBIN**  
Can accommodate 64 SKUs.

ROW	BIN SIZE (HxW)	# BINS
1	4" x 4"	8
2	4" x 4"	8
3	4" x 4"	8
4	4" x 4"	8
5	4" x 4"	8
6	4" x 4"	8
7	4" x 4"	8
8	4" x 4"	8
<b>TOTAL</b>		<b>64</b>

All lengths are 18"

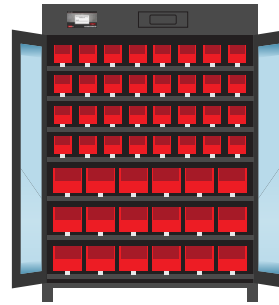

**MEDIUM-CAPACITY 1 SMARTBIN**  
Can accommodate 50 SKUs.

ROW	BIN SIZE (HxW)	# BINS
1	4" x 4"	8
2	4" x 4"	8
3	4" x 4"	8
4	4" x 4"	8
5	6" x 6"	6
6	6" x 6"	6
7	6" x 6"	6
<b>TOTAL</b>		<b>50</b>

All lengths are 18"

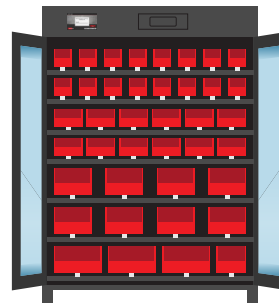

**MEDIUM-CAPACITY 2 SMARTBIN**  
Can accommodate 40 SKUs.

ROW	BIN SIZE (HxW)	# BINS
1	4" x 4"	8
2	4" x 4"	8
3	4" x 6"	6
4	4" x 6"	6
5	6" x 8"	4
6	6" x 8"	4
7	6" x 11"	3
	6" x 6"	1
<b>TOTAL</b>		<b>40</b>

All lengths are 18"

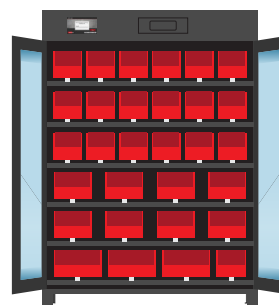

**LOW-CAPACITY SMARTBIN**  
Can accommodate 30 SKUs.

ROW	BIN SIZE (HxW)	# BINS
1	6" x 6"	6
2	6" x 6"	6
3	6" x 6"	6
4	6" x 8"	4
5	6" x 8"	4
6	6" x 11"	3
	6" x 6"	1
<b>TOTAL</b>		<b>30</b>

All lengths are 18"